



Canfield Gardens NW6





## Canfield Gardens, NW6 £475,000 Leasehold

- 2 double bedroom, 2 bathroom apartment
- Private balcony
- Both double bedrooms with en-suite
- 623 sq ft / 57.8 sq m
- Guest WC
- 18'5 open plan kitchen/reception
- 1 minute walk to Finchley Road station (Jubilee and Metropolitan lines)
- Offered chain free



**Parkheath**  
*Sold on Service*

**Camden Tax band D**

Belsize Park/Hampstead  
208 Haverstock Hill  
NW3 2AG  
Sales 020 7431 1234  
Lettings 020 7431 3104  
[nw3@parkheath.com](mailto:nw3@parkheath.com)

Kensal Rise  
54-56 Chamberlayne Rd  
NW10 3JH  
Tel 020 8960 4845  
[kensal@parkheath.com](mailto:kensal@parkheath.com)

South/West Hampstead  
192 West End Lane  
NW6 1SG  
Sales & Lettings  
Tel 020 7794 7111  
[192@parkheath.com](mailto:192@parkheath.com)

Property Management  
192 West End Lane  
NW6 1SG  
020 7433 6174  
[pm@parkheath.com](mailto:pm@parkheath.com)

[www.parkheath.com](http://www.parkheath.com)

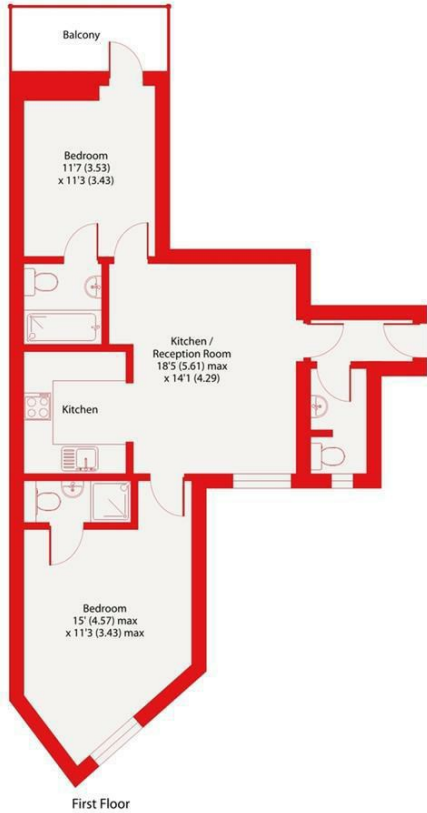

Canfield Gardens, NW6  
 Approximate Area = 623 sq ft / 57.8 sq m  
 For identification only - Not to scale



Floor plan produced in accordance with RICS Property Measurement Standards incorporating International Property Measurement Standards (IPMS2 Residential). © richcom 2024. Produced for Kinleigh Folkard & Hayward. REF: 1089271

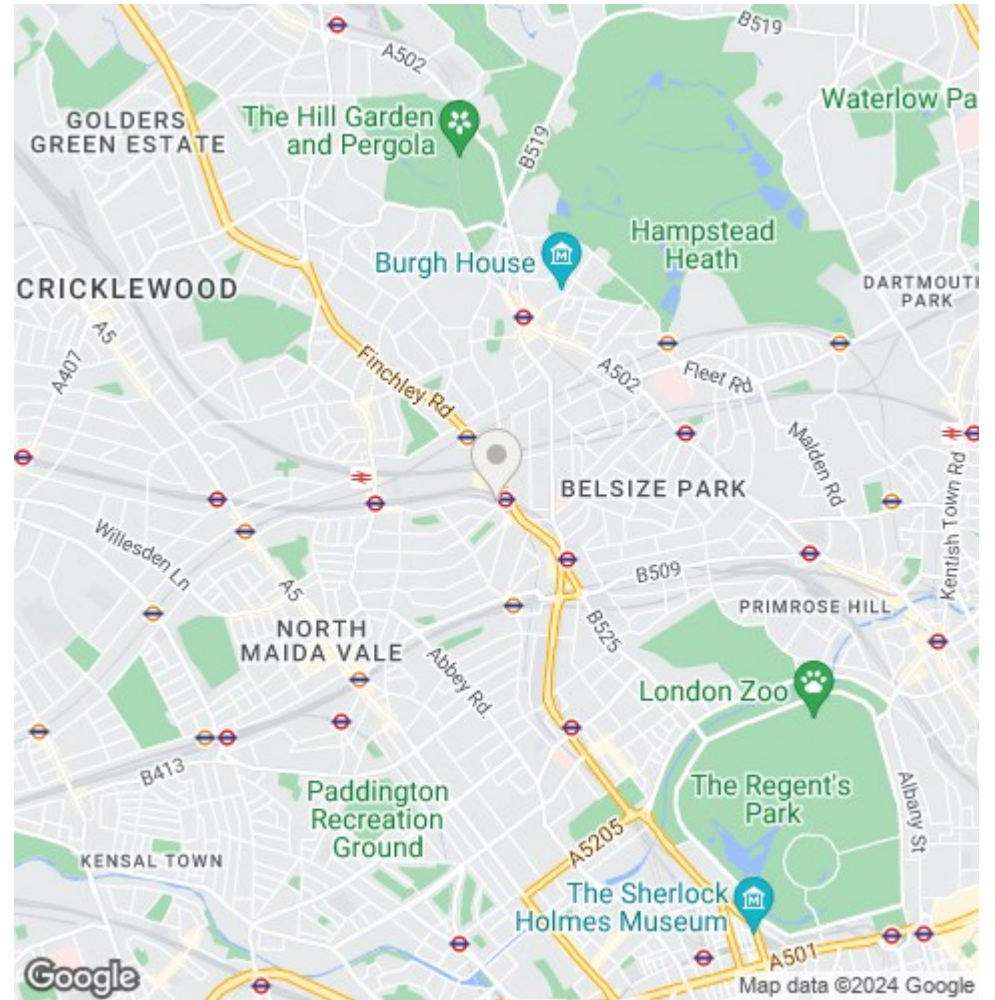

The particulars do not constitute part of an offer or contract. The particulars, including text, photographs and plans, are for the guidance only of prospective purchasers/tenants and must not be relied upon as statements of fact. The descriptions provided therein represent the opinion of the author and whilst given in good faith should not be construed as statements of fact. Nothing in these particulars shall be deemed a statement that the property is in good condition or otherwise or that any services or facilities are in good working order. All measurements are approximate